



## ARCHITRAVE FREE KIT | P7300

For installations where a minimal aesthetic is required or where the door opening needs to be frameless (i.e. without architrave), Portman offers a range of heavy duty steel door linings. These sections enable the skim coat to be applied and the whole frame is then painted / finished to blend in with the surrounding wall.

As standard, kits accommodate doors 38-44mm thick, kits are also supplied with flush bracket sets. For doors over 2700mm high or 1500mm wide, please contact the sales office. For doors over 2400mm high the use of the P5700 reinforcing kit is recommended

N.B Self closing and simultaneous opening (for double doors) cannot be specified with Architrave free/flush bracket sets. Unless the track is recessed into the ceiling the system will have a minimal light gap at the head.



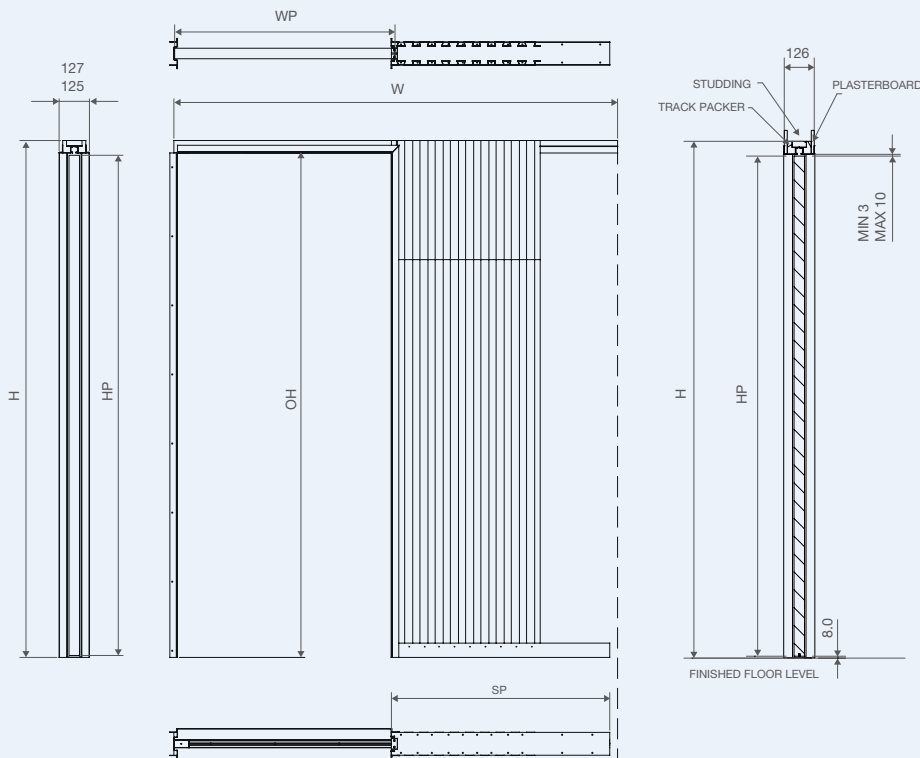

## SINGLE DOOR

(max. door thickness 44mm)

**To calculate studwork width and height from known door dimensions:**

Studwork width (W) = 2 x Door width (WP) + 12mm

Studwork height (H) = Door height (HP) + 60mm

**To calculate door size from known studwork dimensions:**

Door width (WP) = Studwork width (W) - 12mm / 2

Door height (HP) = Studwork height (H) - 60mm

**Door size opening dimensions:**

Door width (WP) = Door opening width (OP) + 28mm

Door height (HP) = Door opening height (OH) - 15mm

**To calculate door opening width and height from known door dimensions:**

Door opening width (OP) = Door width (WP) - 28mm

Door opening height (OH) = Door height (HP) + 15mm

## KITS

**Standard height (up to 2100mm)**

Standard width door leaf

P7300 SDE 626-926mm wide

Intermediate width door leaf

P7300 IDE 927-1300mm wide

Wide door leaf

P7300 WDE 1301-1500mm wide

**Tall height (up to 2700mm)**

Tall door leaf

P7300 TDE 626-926mm wide

Tall/Intermediate width door leaf

P7300 ITDE 927-1300mm wide

Tall/Wide door leaf

P7300 WTDE 1301-1500mm wide

## DOUBLE DOORS

(max. door thickness 44mm)

**To calculate studwork width and height from known door dimensions:**

For double doors: (W) = 4 x (WP) + 18mm

For double doors: (H) = (HP) + 60mm

**To calculate door size from known studwork dimensions:**

For double doors: (WP) = (W) - 18mm / 4

For double doors: (HP) = (H) - 60mm

**Door size opening dimensions:**

For double doors: (WP) = (OP) + 32mm / 2

For double doors: (HP) = (OH) - 15mm

**To calculate door opening width and height from known door dimensions:**

For double doors: (OP) = 2 x (WP) - 32mm

For double doors: (OH) = (HP) + 15mm

## KITS

**Standard height (up to 2100mm)**

Standard width door leaf

P7300 DDE 626-926mm wide

Intermediate width door leaf

P7300 IDDE 927-1300mm wide

Wide door leaf

P7300 WDDE 1301-1500mm wide

**Tall height (up to 2700mm)**

Tall door leaf

P7300 TDDE 626-926mm wide

Tall/Intermediate width door leaf

P7300 ITDDE 927-1300mm wide

Tall/Wide door leaf

P7300 WTDDE 1301-1500mm wide

## + COMPATIBLE ACCESSORIES

Architectural flush pulls

Architectural bathroom set

Pop out pull handle

Leading edge pull

Touch latch

Wall reinforcing kit

## ▢ STANDARD DOOR LEAVES

Flush

2 Panel shadow gap

4 Panel recessed

4 Panel shaker

Vertical boarded door

Glazed door

## ▷ MORE INFORMATION

Website

Installation instructions

CAD files



PORTMAN

P7300 Assembly  
Installation